





www.triumphtraffic.com

LEGEND

-  Sign Stand
-  Closure Area
-  Delineator
-  Survey Area
-  TCP

CONTRACTOR: Vanmars Drilling

DATE: July 10, 2024

CLOSURE DATES: TBD

CLOSURE TIMES: TBD [TMM Sec.18 \(Click Here\)](#)

CLOSURE PURPOSE: Hydrovac work

AUTHOR: Sarah Sutherland

DWG NO: 10072024VMD-001 REV NO.00

CLOSURE LOCATION: Prest Rd between Chilliwack Central Ave and First Ave

CLOSURE DESCRIPTION: Intermittent traffic stops in both directions on Prest Rd between Chilliwack Central Road and First Avenue



NOTES:

- Traffic plans based on a 60km/h speed zone
- Traffic specifications based on the Traffic Management Manual for Work on Roadways(2020)
- TCP ahead and Prepare to Stop signs to be covered or removed when TCP not on site
- Driveway access to be maintained at all times
- Existing lane alignment to be reinstated at the end of each shift
- Device placement and on-going maintenance to be completed by qualified personnel
- Contractor has been notified of the Worksafe BC Occupational Health & Safety Part 18 and it is the contractors responsibility that all workers are in compliant
- Plan to be reviewed prior to work and of any changes are noted, a new risk assessment is to be completed and noted on the FLRA or equivalent

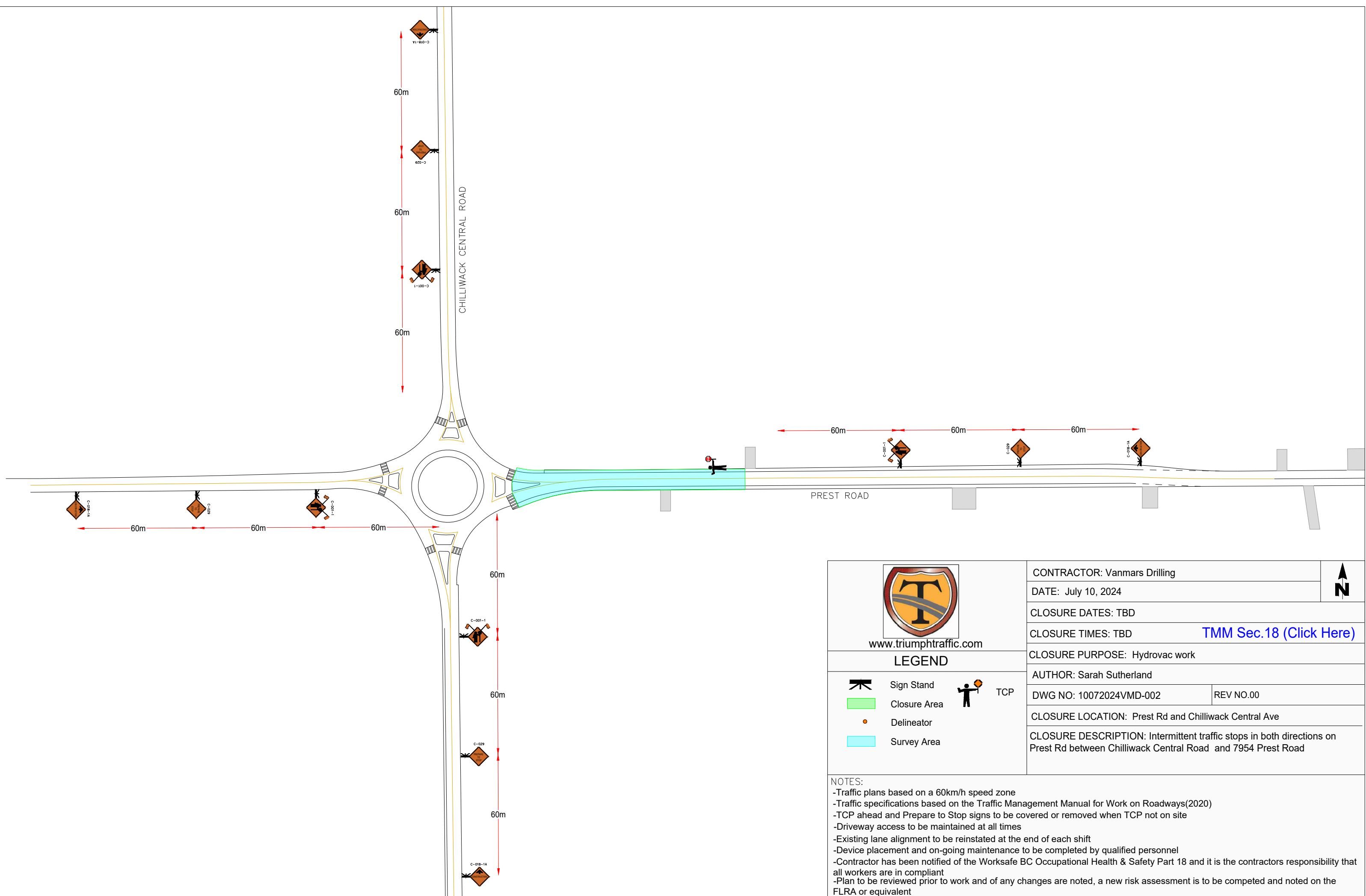

LEGEND	
	Sign Stand
	Closure Area
	Delineator
	Survey Area
	TCP

CONTRACTOR: Vanmars Drilling	
DATE: July 10, 2024	

CLOSURE DATES: TBD
CLOSURE TIMES: TBD TMM Sec.18 (Click Here)

CLOSURE PURPOSE: Hydrovac work

AUTHOR: Sarah Sutherland	
DWG NO: 10072024VMD-002	REV NO.00

CLOSURE LOCATION: Prest Rd and Chilliwack Central Ave

CLOSURE DESCRIPTION: Intermittent traffic stops in both directions on Prest Rd between Chilliwack Central Road and 7954 Prest Road
--

NOTES:

- Traffic plans based on a 60km/h speed zone
- Traffic specifications based on the Traffic Management Manual for Work on Roadways(2020)
- TCP ahead and Prepare to Stop signs to be covered or removed when TCP not on site
- Driveway access to be maintained at all times
- Existing lane alignment to be reinstated at the end of each shift
- Device placement and on-going maintenance to be completed by qualified personnel
- Contractor has been notified of the Worksafe BC Occupational Health & Safety Part 18 and it is the contractors responsibility that all workers are in compliant
- Plan to be reviewed prior to work and of any changes are noted, a new risk assessment is to be completed and noted on the FLRA or equivalent